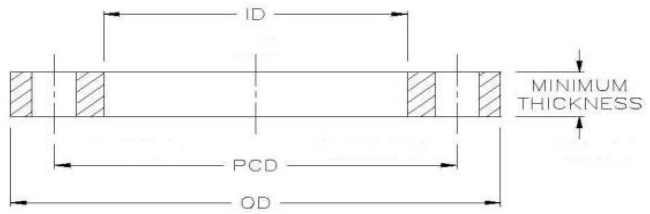

**TABLE D AS2129 HOT DIPPED GALVANISED CARBON STEEL BACKING RINGS (ASTM A36)**

CODE	SIZE	OD (mm)	PCD (mm)	ID (mm)	THICKNESS (mm)	BOLT HOLES NO x Dia(mm)		BOLT SIZE	WEIGHT (Kg)
AUS2129D001	20	95	67	28	8	4	14	M12	0.37
AUS2129D002	25	100	73	34	8	4	14	M12	0.40
AUS2129D003	32	115	83	42	8	4	14	M12	0.53
AUS2129D004	40	120	87	51	8	4	14	M12	0.54
AUS2129D005	50	135	98	62	10	4	14	M12	0.84
AUS2129D006	63	150	114	78	10	4	18	M16	0.93
AUS2129D007	75	165	127	87	10	4	18	M16	1.13
AUS2129D008	90	185	146	108	10	4	18	M16	1.31
AUS2129D009	110	215	178	125	10	4	18	M16	1.81
AUS2129D010	125	255	210	140	13	8	18	M16	3.44
AUS2129D011	140	255	210	155	13	13	18	M16	2.96
AUS2129D012	160	280	235	175	13	8	18	M16	3.63
AUS2129D013	180	280	235	195	13	8	18	M16	3.04
AUS2129D014	200	335	292	230	13	8	18	M16	4.56
AUS2129D015	225	335	292	240	13	8	18	M16	4.18
AUS2129D016	250	405	356	290	16	8	22	M20	7.52
AUS2129D017	280	405	356	300	16	8	22	M20	6.94
AUS2129D018	315	455	406	345	19	12	22	M20	9.65
AUS2129D019	355	525	470	375	22	12	26	M24	17.25
AUS2129D020	400	580	521	430	22	12	26	M24	19.50
AUS2129D021	450	640	584	480	25	12	26	M24	26.43
AUS2129D022	500	705	641	530	29	16	26	M24	36.80
AUS2129D023	560	760	699	590	29	16	30	M27	38.55
AUS2129D024	630	825	756	660	32	16	30	M27	45.61
AUS2129D025	710	910	845	740	35	20	30	M27	56.78

AUS2129D026	800	1060	984	835	41	20	36	M33	101.47
AUS2129D027	900	1175	1092	940	48	24	36	M33	138.21
AUS2129D028	1000	1255	1175	1040	51	24	36	M33	145.71
AUS2129D029	1200	1490	1410	1240	60	32	36	M33	237.69

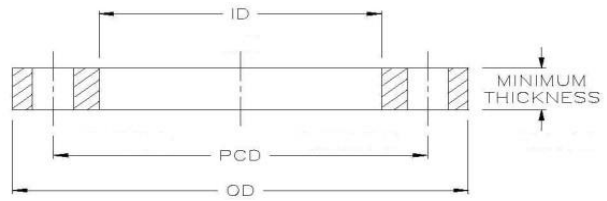



**TABLE E AS2129 HOT DIPPED GALVANISED CARBON STEEL BACKING RINGS (ASTM A36)**

CODE	SIZE	OD (mm)	PCD (mm)	ID (mm)	THICKNE SS (mm)	BOLT HOLES NO		BOLT SIZE	WEIGHT (Kg)
							xDia(mm)		
AUS2129E001	20	95	67	28	8	4	14	M12	0.37
AUS2129E002	25	100	73	34	8	4	14	M12	0.40
AUS2129E003	32	115	83	42	8	4	14	M12	0.53
AUS2129E004	40	120	87	51	8	4	14	M12	0.54
AUS2129E005	50	135	98	62	10	4	14	M12	0.84
AUS2129E006	63	150	114	78	10	4	18	M16	0.93
AUS2129E007	75	165	127	87	10	4	18	M16	1.13
AUS2129E008	90	185	146	108	12	4	18	M16	1.58
AUS2129E009	110	215	178	125	13	8	18	M16	2.25
AUS2129E010	125	255	210	140	14	8	18	M16	3.71
AUS2129E011	140	255	210	155	14	8	18	M16	3.32
AUS2129E012	160	280	235	175	17	8	22	M20	4.61
AUS2129E013	180	280	235	195	17	8	22	M20	3.84
AUS2129E014	200	335	292	230	19	8	22	M20	6.51
AUS2129E015	225	335	292	240	19	8	22	M20	5.96
AUS2129E016	250	405	356	290	22	12	22	M20	10.08
AUS2129E017	280	405	356	300	22	12	22	M20	9.27
AUS2129E018	315	455	406	345	25	12	26	M24	12.34
AUS2129E019	355	525	470	375	29	12	26	M24	22.74
AUS2129E020	400	580	521	430	32	12	26	M24	28.36
AUS2129E021	450	640	584	480	35	16	26	M24	36.42
AUS2129E022	500	705	641	530	38	16	26	M24	48.21
AUS2129E023	560	760	699	590	44	16	30	M27	58.49

AUS2129E024	630	825	756	660	48	16	33	M30	67.52
AUS2129E025	710	910	845	740	51	20	33	M30	81.54
AUS2129E026	800	1060	984	835	54	20	36	M33	133.64
AUS2129E027	900	1175	1092	940	64	24	36	M33	184.28
AUS2129E028	1000	1255	1175	1040	67	24	39	M36	189.19
AUS2129E029	1200	1490	1410	1240	79	32	39	M36	309.45



**TABLE ANSI150 HOT DIPPED GALVANISED CARBON STEEL BACKING RINGS (ASTM A36)**

CODE	SIZE	OD (mm)	PCD (mm)	ID (mm)	THICKNESS (mm)	BOLT HOLES NO× Dia(mm)		BOLT SIZE	WEIGHT (Kg)
AUSANSI001	20	90	60.5	28	8	4	16	M14	0.31
AUSANSI002	25	98	70	34	8	4	16	M14	0.37
AUSANSI003	32	108	79.5	42	8	4	16	M14	0.44
AUSANSI004	40	117	89	51	8	4	16	M14	0.50
AUSANSI005	50	127	98.5	62	10	4	16	M14	0.69
AUSANSI006	63	152	120.5	78	10	4	20	M18	0.95
AUSANSI007	75	178	139.5	87	10	4	20	M18	1.39
AUSANSI008	90	191	152	108	12	4	20	M18	1.72
AUSANSI009	110	229	190.5	125	13	8	20	M18	2.70
AUSANSI010	125	254	216	140	14	8	22	M20	3.55
AUSANSI011	140	254	216	155	14	8	22	M20	3.16
AUSANSI012	160	279	241	175	17	8	22	M20	4.55
AUSANSI013	180	279	241	195	17	8	22	M20	3.77
AUSANSI014	200	343	298.5	230	19	8	22	M20	7.14
AUSANSI015	225	343	298.5	255	19	8	22	M20	5.72
AUSANSI016	250	406	362	290	22	12	26	M24	9.86
AUSANSI017	280	406	362	300	22	12	26	M24	9.06
AUSANSI018	315	483	432	345	25	12	26	M24	16.37
AUSANSI019	355	535	476	373	29	12	30	M27	24.39
AUSANSI020	400	600	540	430	32	16	30	M27	31.73
AUSANSI021	450	635	578	480	35	16	33	M30	33.56
AUSANSI022	500	700	635	530	38	20	33	M30	43.92

AUSANSI023	560	760	692	590	44	20	36	M33	55.27
AUSANSI024	630	815	749	660	48	20	36	M33	60.03
AUSANSI025	710	927	863.5	745	51	20	41	M38	85.18
AUSANSI026	800	1060	978	840	54	28	41	M38	123.59
AUSANSI027	900	1168	1085	940	64	32	41	M38	168.55
AUSANSI028	1000	1289	1200	1040	67	36	41	M38	214.72
AUSANSI029	1200	1510	1422.5	1240	79	44	41	M38	325.86

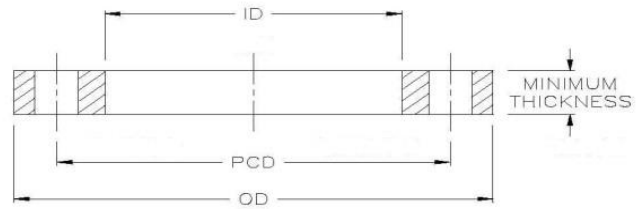

### DIN 16 HOT DIPPED GALVANISED CARBON STEEL BACKING RINGS (ASTM A36)

CODE	SIZE	OD (mm)	PCD (mm)	ID (mm)	THICKNES S (mm)	HOLES NO× Dia(mm)		BOLT SIZE	WEIGHT (Kg)
AUS-DIN01	32	115	85	44	12	4	14	M12	0.78
AUS-DIN02	40	140	100	52	14	4	18	M16	1.35
AUS-DIN03	50	150	110	62	14	4	18	M16	1.50
AUS-DIN04	63	165	125	78	16	4	18	M16	1.96
AUS-DIN05	75	185	145	92	16	8	18	M16	2.29
AUS-DIN06	90	200	160	108	18	8	18	M16	2.86
AUS-DIN07	110	220	180	128	18	8	18	M16	3.27
AUS-DIN08	125*4"	220	180	140	18	8	18	M16	2.92
AUS-DIN09	125*5"	250	210	140	25	8	18	M16	6.23
AUS-DIN10	140	250	210	158	18	8	18	M16	3.89
AUS-DIN11	160	285	240	178	20	8	22	M20	5.64
AUS-DIN12	180	285	240	195	20	8	22	M20	4.86
AUS-DIN13	200	340	295	235	24	12	22	M20	8.09
AUS-DIN14	225	340	295	240	24	12	22	M20	7.74
AUS-DIN15	250	405	355	290	30	12	26	M24	13.31
AUS-DIN16	280	405	355	300	30	12	26	M24	12.22
AUS-DIN17	315	460	410	345	34	12	26	M24	17.75



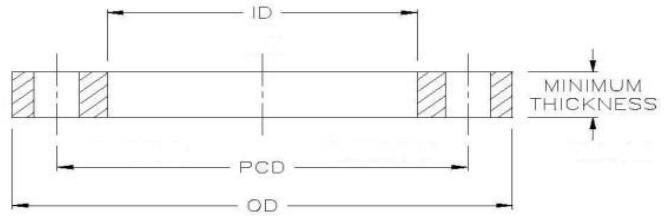

CHINA PUMP HOT DIPPED GALVANISED CARBON STEEL BACKING RINGS (ASTM A36)									
SIZE	CODE	OD (mm)	PCD (mm)	ID (mm)	NESS (mm)	HOLES NO× Dia(mm)		BOLT SIZE	WEIGHT (Kg)
6"160/180	CPF150	256	210	185	15	6	16	M14	2.76
8"200/225	CPF200	310	270	230	18	6	18	M16	4.59
10"250/280	CPF250	364	320	290	18	8	18	M16	5.10
12" 315	CPF300	440	380	345	18	8	18	M16	8.01

**TABLE D AS2129 HOT DIPPED GALVANISED CARBON STEEL BLIND FLANGES (ASTM A36)**

SIZE	CODE	OD (mm)	PCD (mm)	ID (mm)	NESS (mm)	HOLES NO× Dia(mm)		BOLT SIZE	WEIGHT (Kg)
110-4"	GBF110D	215	178	N/A	10	4	18	M16	2.78
250-10"	GBF250D	405	356	N/A	16	8	22	M20	15.84
450-18"	GBF450D	640	584	N/A	25	12	26	M24	62.03
500-20"	GBF500D	705	641	N/A	29	16	26	M24	87.14
560-22"	GBF560D	760	699	N/A	32	16	30	M27	111.38
630-24"	GBF630D	825	756	N/A	32	16	33	M27	131.15
710-28"	GBF710D	910	845	N/A	35	20	33	M27	174.41
800-32"	GBF800D	1060	984	N/A	41	20	36	M33	278.13
1000-40"	GBF1000D	1255	1175	N/A	51	24	36	M33	486.61

**TABLE E AS2129 HOT DIPPED GALVANISED CARBON STEEL BLIND FLANGES (ASTM A36)**

SIZE	CODE	OD (mm)	PCD (mm)	ID (mm)	NESS (mm)	HOLES NO× Dia(mm)		BOLT SIZE	WEIGHT (Kg)
20-1/2"	GBF20E	95	67	N/A	6	4	14	M12	0.31
25-3/4"	GBF25E	100	73	N/A	6	4	14	M12	0.34
32-1"	GBF32E	115	83	N/A	7	4	14	M12	0.54
40-1 1/4"	GBF40E	120	87	N/A	8	4	14	M12	0.67
50-1 1/2"	GBF50E	135	98	N/A	9	4	14	M12	0.97
63-2"	GBF63E	150	114	N/A	10	4	18	M16	1.31
75-2 1/2"	GBF75E	165	127	N/A	10	4	18	M16	1.60
90-3"	GBF90E	185	146	N/A	12	4	18	M16	2.44
110-4"	GBF110E	215	178	N/A	13	8	18	M16	3.51
125-5"	GBF125E	255	210	N/A	14	8	18	M16	5.40
160-6"	GBF160E	280	235	N/A	17	8	22	M20	7.83
200-8"	GBF200E	335	292	N/A	19	8	22	M20	12.72
250-10"	GBF250E	405	356	N/A	22	12	22	M20	21.51
315-12"	GBF315E	455	406	N/A	25	12	26	M24	30.73
355-14"	GBF355E	525	470	N/A	29	12	26	M24	47.94
400-16"	GBF400E	580	521	N/A	32	12	26	M24	64.92

450-18"	GBF450E	640	584	N/A	32	16	26	M24	78.86
500-20"	GBF500E	705	641	N/A	38	16	26	M24	114.18
560-22"	GBF560E	760	699	N/A	44	16	30	M27	153.15
630-24"	GBF630E	825	756	N/A	48	16	33	M30	196.73

**ANSI 150 HOT DIPPED GALVANISED CARBON STEEL BLIND FLANGES (ASTM A36)**

SIZE	CODE	OD (mm)	PCD (mm)	ID (mm)	THICKNESS (mm)	BOLT HOLES NO× Dia(mm)		BOLT SIZE	WEIGHT (Kg)
20-1/2"	GBF20A	90	60.5	N/A	6	4	16	1/2"	0.26
25-3/4"	GBF25A	98	70	N/A	8	4	16	1/2"	0.42
32-1"	GBF32A	108	79.5	N/A	8	4	16	1/2"	0.53
40-1 1/4"	GBF40A	117	89	N/A	8	4	16	1/2"	0.63
50-1 1/2"	GBF50A	127	98.5	N/A	10	4	16	1/2"	0.93
63-2"	GBF63A	152	120.5	N/A	10	4	20	5/8"	1.33
75-2 1/2"	GBF75A	178	139.5	N/A	10	4	20	5/8"	1.86
90-3"	GBF90A	191	152	N/A	12	4	20	5/8"	2.59
110-4"	GBF110A	229	190.5	N/A	12	8	20	5/8"	3.65
125-5"	GBF125A	254	216	N/A	16	8	23	3/4"	5.96
160-6"	GBF160A	279	241	N/A	16	8	23	3/4"	7.28
200-8"	GBF200A	343	298.5	N/A	20	8	23	3/4"	14.02
250-10"	GBF250A	406	362	N/A	20	12	26	7/8"	19.37
315-12"	GBF315A	483	432	N/A	25	12	26	7/8"	34.79
355-14"	GBF355A	535	476	N/A	28	12	29	1"	47.78
400-16"	GBF400A	600	540	N/A	32	16	29	1"	68.53
450-18"	GBF450A	635	578	N/A	36	16	32	1 1/8"	86.06
500-20"	GBF500A	700	635	N/A	29	20	32	1 1/8"	84.15
560-22"	GBF560A	750	692	N/A	32	20	35	1 1/4"	106.39
630-24"	GBF630A	813	749	N/A	32	20	35	1 1/4"	125.87

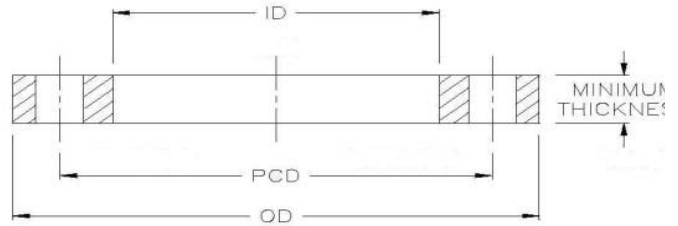

**TABLE D/E AS2129 - 316 STAINLESS STEEL BACKING RINGS**

SIZE	CODE	OD (mm)	PCD (mm)	ID (mm)	THICKNE SS (mm)	BOLT HOLES NO×Dia(mm)		BOLT SIZE	WEIGHT (Kg)
20-1/2"	316BR20E	95	67	32	8	4	14	M12	0.36
25-3/4"	316BR25E	100	73	37	8	4	14	M12	0.39
32-1"	316BR32E	115	83	44	8	4	14	M12	0.52
40-11/4"	316BR40E	120	87	52	8	4	14	M12	0.54
50-11/2"	316BR50E	135	98	62	9	4	14	M12	0.76
63-2"	316BR63E	150	114	78	10	4	18	M16	0.93
75-21/2"	316BR75E	165	127	92	10	4	18	M16	1.08
90-3"	316BR90E	185	146	108	12	4	18	M16	1.58
110-4"	316BR110D	215	178	128	10	4	18	M16	1.76
110-4"	316BR110E	215	178	128	13	8	18	M16	2.19
125-4"	316BR1254E	215	178	140	13	8	18	M16	1.93
125-5"	316BR1255E	255	210	140	14	8	18	M16	3.71
140-5"	316BR140E	255	210	158	14	8	18	M16	3.24
160-6"	316BR160E	280	235	178	17	8	22	M20	4.50
180-6"	316BR180E	280	235	195	17	8	22	M20	3.84
200-8"	316BR200E	335	292	235	19	8	22	M20	6.24
225-8"	316BR225E	335	292	240	19	8	22	M20	5.96
250-10"	316BR250D	405	356	290	16	8	22	M20	7.52
250-10"	316BR250E	405	356	290	22	12	22	M20	10.08
315-12"	316BR315E	455	406	345	25	12	26	M24	12.34
355-14"	316BR355E	525	470	376	29	12	26	M24	22.61

**ANSI 150 - 316 STAINLESS STEEL BACKING RINGS**

SIZE	CODE	OD (mm)	PCD (mm)	ID (mm)	THICKNE SS (mm)	BOLT HOLES NO×Dia(mm)		BOLT SIZE	WEIGHT (Kg)
20-1/2"	316BR20A	90	60.5	32	8	4	16	1/2"	0.30
25-3/4"	316BR25A	98	70.0	37	8	4	16	1/2"	0.36
32-1"	316BR32A	108	79.5	44	8	4	16	1/2"	0.43

40-1 1/4"	316BR40A	117	89.0	52	8	4	16	1/2"	0.49
50-1 1/2"	316BR50A	127	98.5	62	10	4	16	1/2"	0.70
63-2"	316BR63A	152	120.5	78	10	4	20	5/8"	0.95
75-2 1/2"	316BR75A	178	139.5	92	10	4	20	5/8"	1.34
90-3"	316BR90A	191	152.0	108	12	4	20	5/8"	1.72
110-4"	316BR110A	229	190.5	125	12	8	20	5/8"	2.49
125-4"	316BR1254A	229	190.5	140	12	8	20	5/8"	2.20
125-5"	316BR125A	254	216.0	140	16	8	23	3/4"	4.02
140-5"	316BR140A	254	216.0	158	16	8	23	3/4"	3.49
160-6"	316BR160A	279	241.0	175	16	8	23	3/4"	4.25
180-6"	316BR180A	279	241.0	195	16	8	23	3/4"	3.52
200-8"	316BR200A	343	298.5	230	20	8	23	3/4"	7.48
225-8"	316BR225A	343	298.5	240	20	8	23	3/4"	6.90
250-10"	316BR250A	406	362.0	290	20	12	26	7/8"	8.98
280-10"	316BR280A	406	362.0	300	20	12	26	7/8"	8.25
315-12"	316BR315A	483	432.0	345	25	12	26	7/8"	16.40
355-14"	316BR355A	535	476.0	376	28	12	29	1"	23.32

**TABLE D/E AS2129 - 316 STAINLESS STEEL BLIND FLANGES**

SIZE	CODE	OD (mm)	PCD (mm)	ID (mm)	THICKNE SS (mm)	BOLT HOLES NO×Dia(mm)		BOLT SIZE	WEIGHT (Kg)
90-3"	316BF90E	185	146	N/A	12	4	18	M16	2.44
110-4"	316BF110E	215	178	N/A	13	8	18	M16	3.51
160-6"	316BF160E	280	235	N/A	17	8	22	M20	7.83
200-8"	316BF200E	335	292	N/A	19	8	22	M20	12.72

M  
SS

11  
—